



CLEAN POWER  
MANAGEMENT

24941 DANA POINT HARBOR DR  
SUITE C220  
DANA POINT, CA 92629  
469-735-2234

This document is © by the engineer and is considered an instrument of service and is only for use with respect to the project as indicated below. All rights reserved. This document may not be reproduced without the prior written consent of the engineer.

SEAL:



PROJECT:

PROJ-1183

MA SOUTHBRIDGE A  
0 CLEMENCE HILL ROAD  
SOUTHBRIDGE, MA  
42.092797, -72.035324

APN: 017-001-00001

OWNER:

PROJECT SOUTHBRIDGE MA  
1, LLC (CONED)

24941 DANA POINT HARBOR  
DR., C220, DANA POINT, CA  
92629

Revisions:

Rev	Date	Description
1	05/02/22	equipment changes
2	08/25/22	equipment changes
3	08/31/22	Utility Restudy
4	10/03/22	Utility Restudy, add sh. E3.01
5	10/17/22	Utility Restudy, relay settings
6	05/30/23	Re-Design using Solectria equip.
7	06/12/23	Grounding XFMR update
8	08/03/23	Updated Pole Design
9	08/09/23	Updated Pole Design

Drawn By: DL Checked By: DS

Date: 06/09/2023 Job No.:

Sheet Title:

ELECTRICAL  
SITE PLAN

Sheet No.:

E-1.0

SHEET NOTES

- SEE ELECTRICAL DETAILS FOR TRENCH DEPTH, CONDUIT CHAIRS AND PROPER CONDUIT TO CONDUIT SPACING REQUIREMENTS.
- IT IS THE RESPONSIBILITY OF THE SUBCONTRACTOR TO HAVE ALL UNDERGROUND UTILITIES MARKED PRIOR TO CONSTRUCTION.
- CONNECTORS SHALL BE THE SAME MANUFACTURER AS THOSE ON THE PV MODULES.
- REFER TO STRUCTURAL PLANS FOR REQUIRED SEPARATION DISTANCE BETWEEN EXCAVATIONS AND RACKING FOUNDATIONS.
- SUBCONTRACTOR TO PROVIDE PULL CALCULATIONS FOR EACH MV CABLE RUN, VERIFYING CABLE INSTALLED TO MANUFACTURER'S SPECIFICATION FOR CABLE TENSION AND SIDE WALL PRESSURE.
- LOCATION OF UTILITY POLES SHALL BE COORDINATED WITH UTILITY, VERIFIED IN FIELD AND APPROVED BY VALTA ENGINEERING AND EOR. GUY WIRES FOR POLES SHALL NOT BE PLACED IN WETLAND AREAS.
- PROVIDE SEPARATE HANDHOLES FOR MV, COMMUNICATIONS, AND LV (DC AND AC) CONDUITS AS REQUIRED FOR WIRE PULLING AND CODE COMPLIANCE. SUBCONTRACTOR TO PROVIDE SUBMITTAL FOR HANDHOLE.
- CONDUIT RUNS SHOWN ARE INDICATIVE OF PATH AND CONVEY ORIGIN AND TERMINATION. SUBCONTRACTOR TO DETERMINE BEST ROUTE PER FIELD CONDITIONS. FINAL CONDUIT PATH SHALL BE APPROVED WITH VALTA ENGINEERING PRIOR TO INSTALLATION.
- INSTALLATION ON UTILITY SIDE OF PCC SHALL COMPLY WITH UTILITY REQUIREMENTS. STANDARDS TO BE PROVIDED BY VALTA ENGINEERING.
- UTILITY OWNED EQUIPMENT IS SHOWN FOR REFERENCE PURPOSES ONLY. IT IS NOT FOR CONSTRUCTION AND MAY BE CHANGED BY THE UTILITY AT ANY TIME.
- FINAL LOCATION OF UTILITY POLES TO BE CONFIRMED BY THE UTILITY.

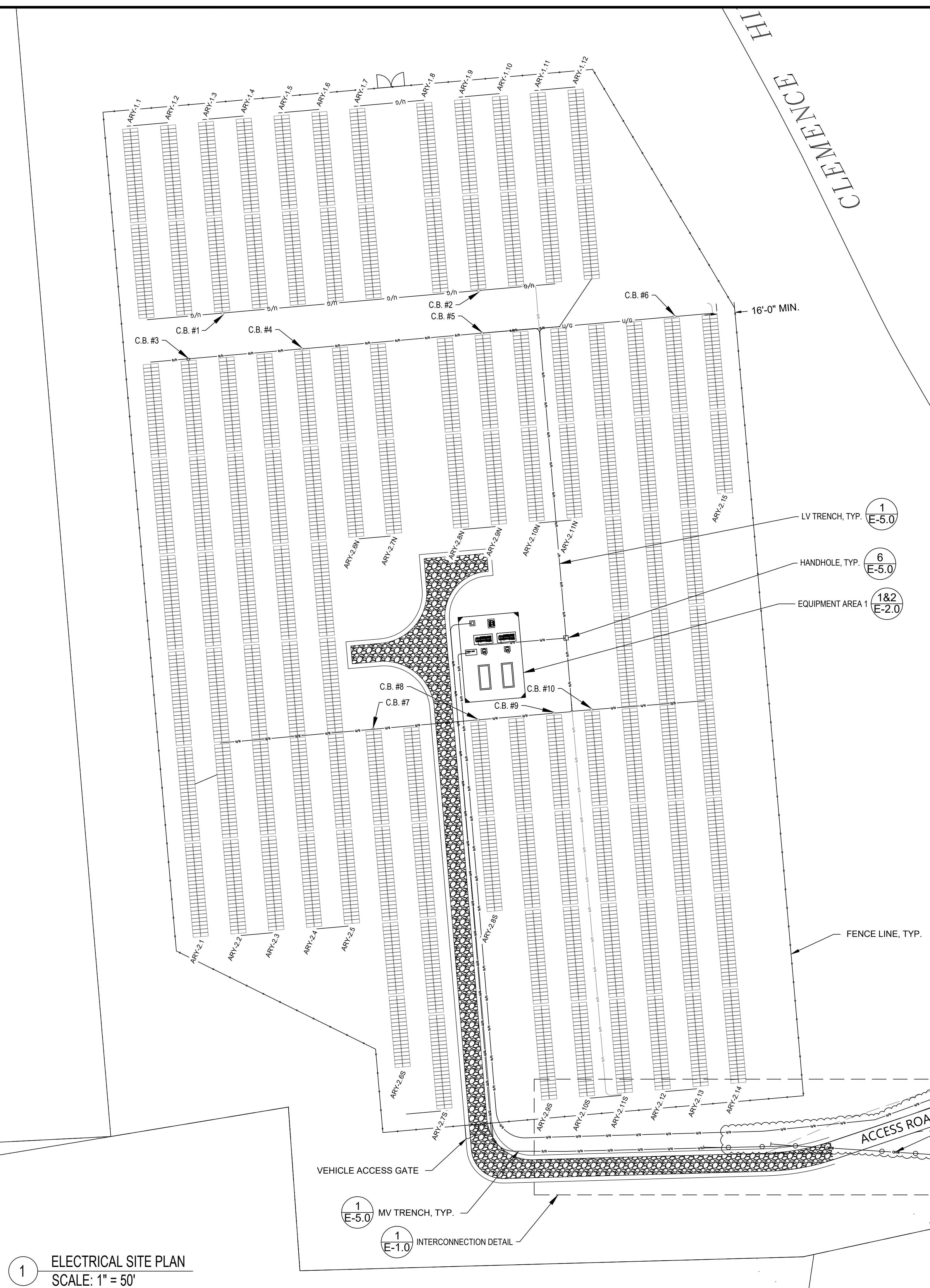
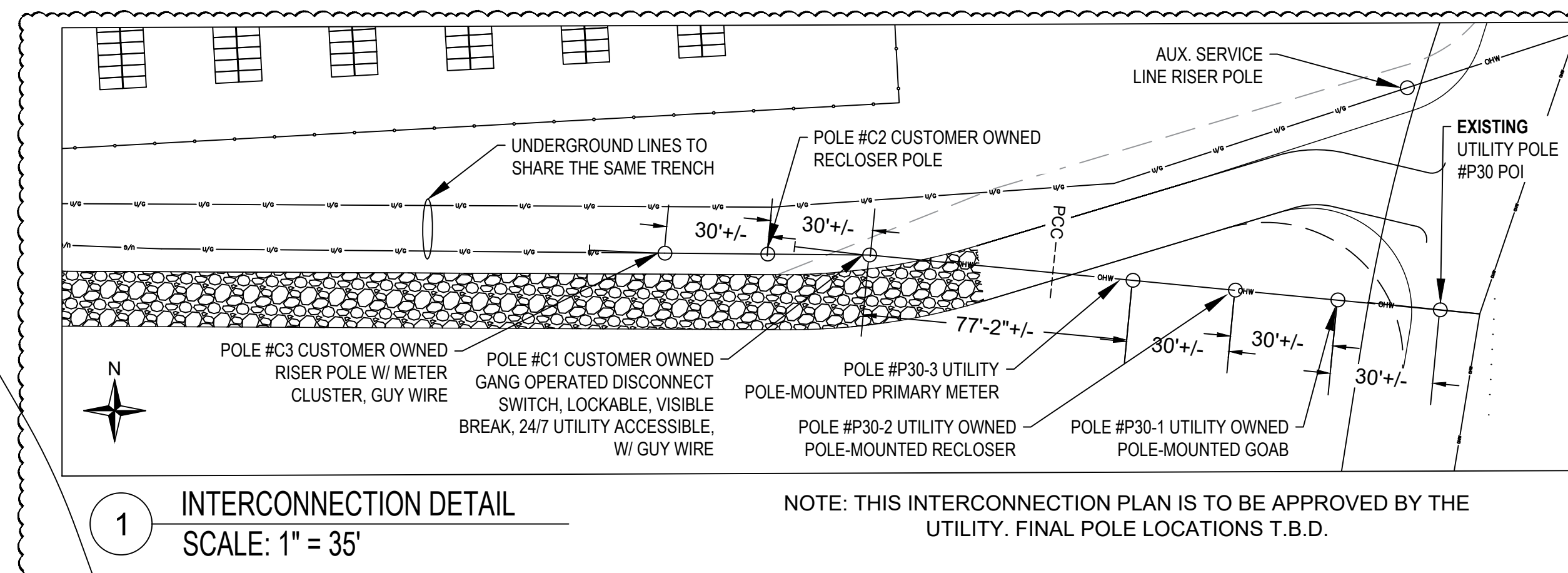

8